

CROSS BRACING

- FOR 12" PIPE AND SMALLER, USE 3"x 3"x $\frac{7}{16}$ " ANGLES.
- FOR 15"-18" PIP, USE 4"x 4"x $\frac{5}{16}$ " ANGLES.
- FOR 20"-24" PIPE, USE 5"x 5"x $\frac{3}{8}$ " ANGLES

CROSS BRACING
(CUT WEB AND BEND)

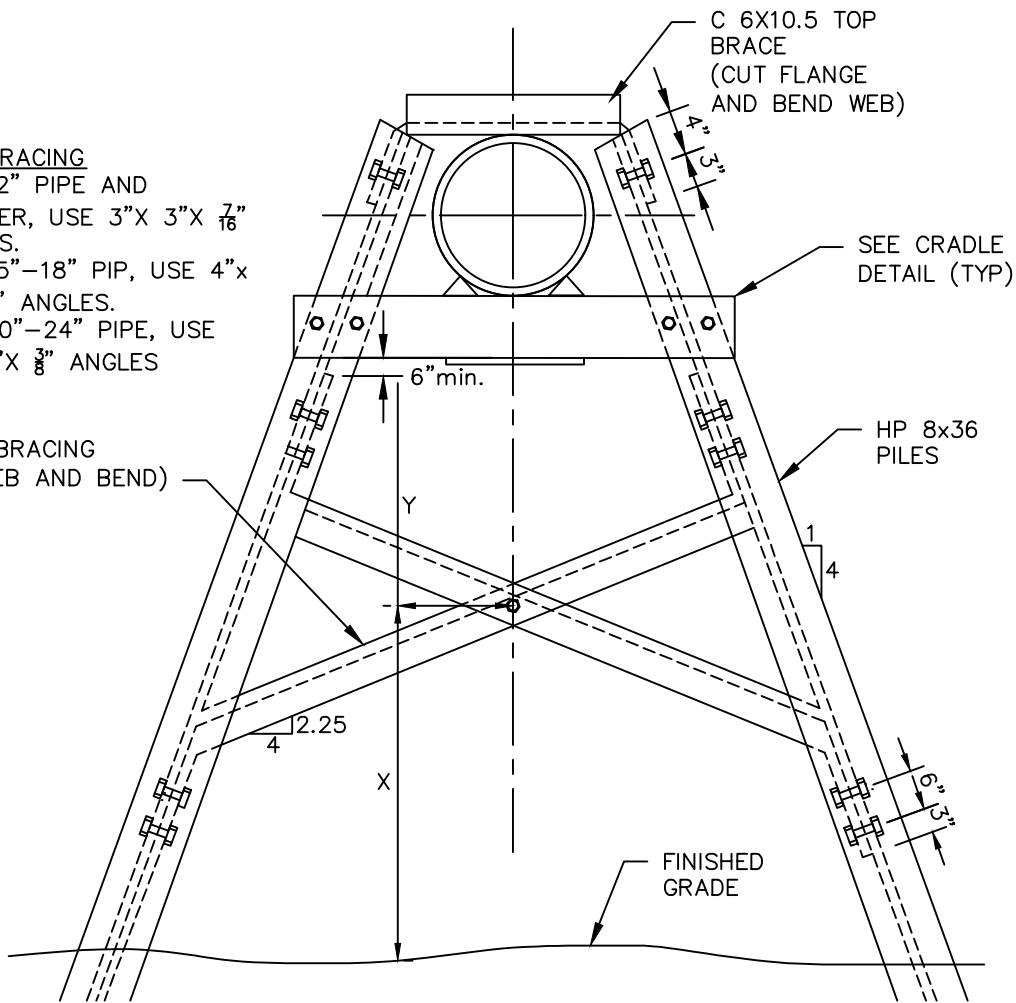

NOTES

1. MAXIMUM HEIGHT FROM PIPE TO UNDISTURBED SOIL IS TO BE 20 FEET.
2. PIPE SHALL FIT SNUGLY.
3. X SHALL EQUAL Y OR AS APPROVED.
4. FOR 8"-18" PIPE, ALL BOLTS SHALL BE $\frac{7}{8}$ " IN DIAMETER AND MEET ASTM A325. FOR 24" PIPE, BOLTS ON THE CRADLE SHALL BE 1" IN DIAMETER AND MEET ASTM A490. BOLTS SHALL BE AT LEAST 2 $\frac{1}{2}$ " LONG. PLAIN ROUND WASHERS WILL BE REQUIRED.
5. BOLT HOLES SHALL BE $\frac{1}{16}$ " LARGER THAN THE DIAMETER OF THE BOLT AND SHALL BE DRILLED.
6. ALL STEEL SHALL BE A36 STEEL.
7. SEE STEEL H-PILES SPECIFICATIONS.
8. PILES SHALL BE DRIVEN TO A MINIMUM DEPTH OF TEN (10) FEET BELOW GROUND OR AS DIRECTED BY THE ENGINEER.
9. PILES SHALL BE DRIVEN TO A DEPTH AT WHICH PILE BEARING CAPACITY IS TWENTY (20) TONS OR AS APPROVED BY THE ENGINEER.
10. THESE PIERS SHALL BE USED FOR DUCTILE IRON PIPE OR HIGH STRENGTH STEEL PIPE ONLY.
11. CONTRACTOR MAY SUBSTITUTE W8X35 FOR HP8X36 FOR THE PILES.

CITY OF ROCK HILL
UTILITIES DEPARTMENT
757 S. ANDERSON ROAD
ROCK HILL, SC 29730



STANDARD DETAIL

H-PILES FOR SEWER CROSSING

REVISIONS:	DATE:	FILE NAME
	FEB. 2018	13.19
	SCALE:	
	N.T.S.	